



The History of Marner

This presentation highlights the key dates and events of Marner's history. Documents held by the school show data, from the census records, of the families of past pupils. The impact on Marner School during World War 1 and World War 2 is recorded. Key events are listed alongside the Marner timeline showing what was happening in Britain during those time periods.



1872 - Marner School was built, it was originally known as Mary Street School. The land was bought for £1,000, the school was built at a cost of £5,578 by Mr W E Nightingale.

1873 - The Education Department transferred children to Mary Street from George Street, Bromley and Park Street, Bromley permanently and by 18th August the school had fully opened with 900 children.

1881 - The name of the school was changed to Marner School.

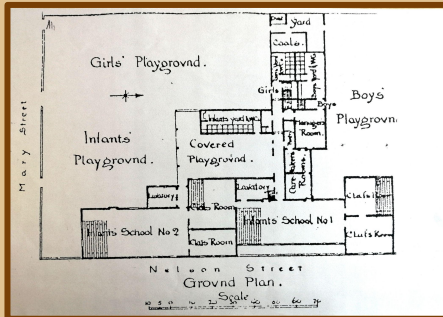
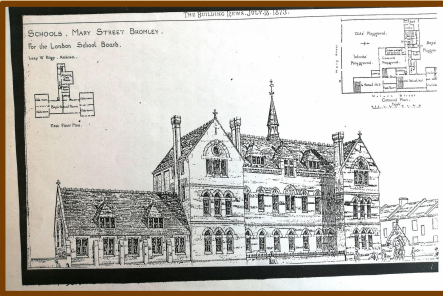

1870s - 1880s

Queen Victoria was on the throne (Ruled: 1837-1901).

1870 Education Act: Introduced by W E Forster, aimed to provide elementary education for all children, creating a national school system.

1871 Trade Union Act: Formally legalised trade unions.

1880: Education compulsory for all children up to aged 10.

1881: Natural History Museum was opened.

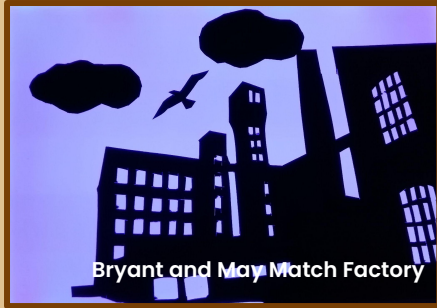

Bryant and May Match Factory



House Number	Name	Age	Occupation
41	James Walker	64	Labourer
41	Annie Walker	62	Housewife
41	James Walker	28	None
43	Charles Day	65	Gas Stoker
43	Jane Day	60	Housewife
43	Joseph Day	19	Gas Stoker
43	Walley Day	13	None
43	Harriett Day	25	Brush Maker
43	Jane Day	17	Brush Maker
43	Walter Pursuer	40	Brush Maker
43	Mary Pursuer	35	Brush Maker
45	Charles Emery	40	Docker
45	Susan Emery	46	Housewife
45	Thomas Woods	47	Docker
45	Florence Woods	20	Housewife
47	Eliza Hutchins	27	Starcher Wash
47	Alfred Hutchins	5	Scholar
47	James Hutchins	7	Scholar
47	Edith Hutchins	13	Gas Stoker

Marnor Log book 1895

1888 - There were 40 children to a class and families paid 2p per child per week. Most families were very poor, many of the men worked down the docks and the women and children in the local Bryant and May match factory. Listed on the census of the time, professions of the families included - Lighterman, Brushmaker, Docker and Gas Stoker.

1911 - The school was expanded at a cost of £15,000. Three new halls and four new classrooms were built, the roof renovated and the walls heightened. The building had a new nursery on the ground floor. The school now accommodated 1196 pupils. Mr J House the Headmaster retired having been the Headteacher for 37 years since the school opened.

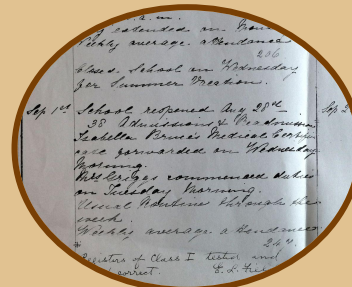
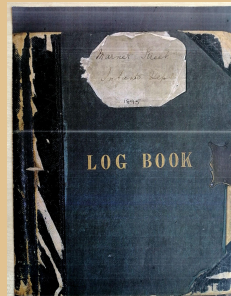

1880s - 1910s

In July 1888, the women and teenage girls working at the Bryant & May match factory in Bow, London, England went on strike due to poor conditions, they took their case to parliament and won.

Married Women's Property Act: Passed in 1882-1883 allowing women to own property and earn their own wages.

1901: Death of Queen Victoria and accession of Edward VII.

MARNER STREET L.C.C. SCHOOL

E.S.N. BROMLEY. 9:2:1923

UNVEILING OF WAR MEMORIAL.

On Wednesday, the 31st ulto., the Right Rev. the Lord Bishop of Stepney unveiled the war memorial which has been erected at Marner-street L.C.C. School, Bromley to the memory of old Marner boys who fell in the great war.

The dedication took place in the school hall, where there were assembled some of the officials of the L.C.C., the school managers and staff, and the parents and relatives of those whose names are commemorated, the visitors being received by Mr. T. R. Rand, the headmaster.

The solemn proceedings were opened with the hymn, "For all the Saints," which was led by a choir of boys and girls. After appropriate prayers, the Union Jack, which veiled the memorial, was removed, and all present stood at the salute.

The Lord Bishop of Stepney then said "Let us remember in silent reverence the dear lads whose names you have recorded here."

Arkwright's "Supreme Sacrifice" having been sung, the Lord Bishop delivered an appropriate address. Kipling's Recessional and the National Anthem brought a very impressive service to a close.

The memorial contains the names of no less than 93 old Marner boys; a splendid record for one school.

1923 - Marner old boys were remembered with the unveiling of a War Memorial, the dedication by The Lord Bishop of Stepney took place in the school hall. Ninety-three Marner boys sadly lost their lives during World War 1. The Memorial was wall-mounted, a wooden triptych, with coat of arms at the top centre and names on the inside of the doors.

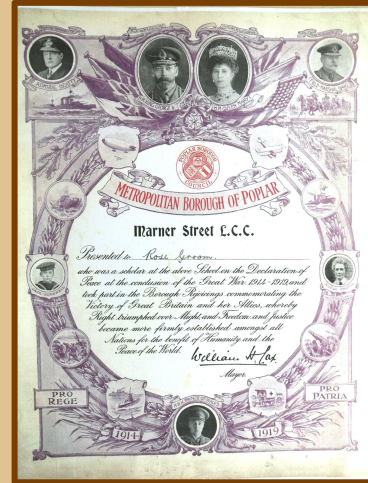
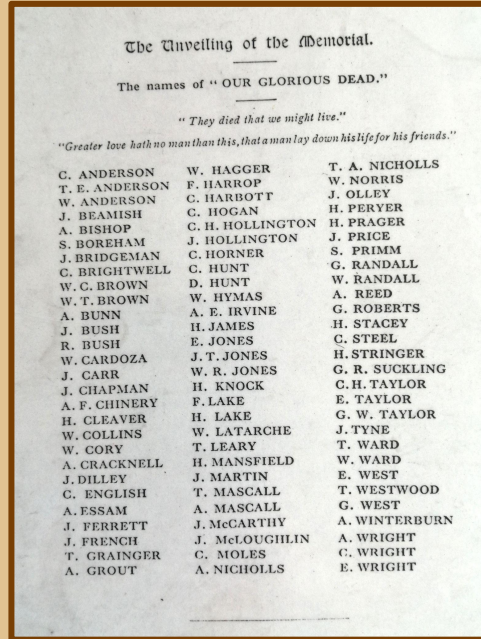

Certificate awarded by The Mayor of Poplar to Rose Groom, a Scholar at Marner, on declaration of peace at the conclusion of WW1.

1910s - 1920s

World War 1 (1914-1918).

1910: George V became King.

1918: Women over 30 gained the vote.

1919: Nancy Astor became the first woman to sit in Parliament.

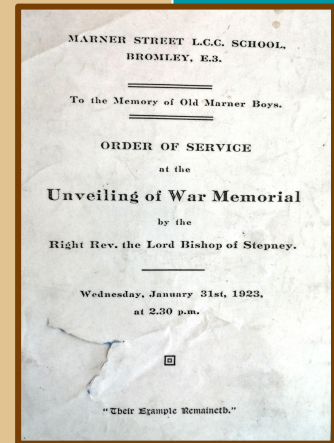



1940 - Marner Primary School suffered badly during World War 2 when bombs were dropped during a day known as Black Saturday. Black Saturday refers to the first mass bombing raid on London during WW2 on September 7th 1940, which began The Blitz. Fortunately, due to it being a Saturday children were not at school and thankfully there were no fatalities.



Clement Attlee and The Mayor of Poplar inspecting St Barnabas Church in Bow following the bombing in 1942.



Mahatma Gandhi visiting Kingsley Hall Community Centre

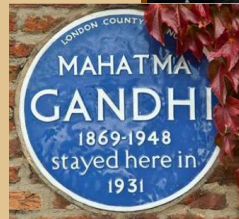

1930s - 1940s

World War 2
(1939-1945).

1931: The great depression - global economic downturn with high rates of unemployment and poverty.

1931: Mahatma Gandhi visited England to discuss constitutional reform in India with British politicians. While in London he stayed at the community centre, Kingsley Hall in Bow, where he is now commemorated with a blue plaque.

1936: Year of three Kings - George V dies, Edward VIII succeeds. Then abdicates to marry Wallis Simpson, George VI ascends to the throne.



1965 - Marner Primary School children at play.

Records of the Headteacher's log of the day to day running of the school and school events ie. building works, changes of teachers and holidays. Record of behaviour issues and punishment logged.

17. 4. 65 *First year - Harrogate*
 26. 4. 65 Mr Lewis - Unattached Schoolkeeper - house now occupied
 27. 7. 65 School books up for summer holiday.
 6. 9. 65 Occasional closure - Magna Carta Holiday
 7. 9. 65 School returned after summer holiday.
 Miss Goodson - Infant Staff - transferred to St Matthias - 8.14 - a good keen teacher
 Mrs Moffatt - Junior Staff - transferred to part-time teaching in Redbridge - a good conscientious teacher
 Miss Ness - Junior Staff - joined the staff from college.
 Mrs Atwood and Mrs Greengrass coping with Infant School.
 New sanitary blocks finished and in use.
 School still decomposed owing to Nursery Playroom being out of use - no line of floor in dangerous state - old line removed but

25.10.65 Half
 24.10.65
 2.11.65 Class 1 exhibits
 7.11.65 bare
 8.11.65 School of name
 9.11.65 Photo
 15.11.65

sancti-
 garden
 the old
 A par
 teachers
 Maria
 fine
 list of
 them.
 children
 over in
 Half
 Class 1
 exhibits
 bare
 School
 of name
 evening
 Photo

Date	Name of Child	Age	Class	Offence	Amount of Punishment	Signature of Head - or Master who inflicted the Punishment	Signature of Parent
8-10-65			9	fighting during a lesson.	1 on seat	H.J. Giblett	Parent
11-10-65			8	disrespectful			Parent
			8	disregard of school rules	1 on seat	H.J. Giblett	Parent
19.10.65			8	Hydrophobic during dance	1 on seat	P.D. Whickel	Parent
2.12.65			9	misbehaving			Parent
2.12.65			10	absence on school	1 on seat	P.D. Whickel	Parent
2.12.65			10	cutting			Parent
6-12-65			4	disrespectful	line hand	H.J. Giblett	Parent
				disobedience			Parent
15-12-65			7	Lying to two boys	1 on seat	H.J. Giblett	Parent
24.1.66			9	misbehaving	1 on seat	H.J. Giblett	Parent
			9	during assembly			Parent
10-2-66			7	disrespectful	1 on seat	H.J. Giblett	Parent
18-2-66			10	disrespectful	1 on seat	P.D. Whickel	Parent
5-3-66			10	disrespectful	1 on seat	H.J. Giblett	Parent
3-3-66			7	disrespectful	2 on seat	P.D. Whickel	Parent

Miss Atwood and Mrs Greengrass coping with Infant School. 7.11.65

1960s - 1970s

1964 - Harold Wilson (Labour) became Prime Minister.

1965 Race Relations Act: First legislation in the UK to address discrimination.

1966 - England won the world cup.

Expansion of South Asian Communities throughout the 1960s, the number of Indian and Pakistani residents in the UK grew significantly.

Throughout the 1960s and 1970s major redevelopment of housing, road infrastructure and demolition of Edwardian and Victorian houses.

1980s - In the 1980s a helicopter landed in the school playground, it was an emergency as a sick patient was being transported to Poplar Hospital (Known as The Dockers Hospital) that was close to Marner School. All the children rushed to the windows to watch the sight.



Air Ambulance



Poplar Hospital

1980s - 1990s

1982: The Falklands War against Argentina, boosting Thatcher's popularity.

1984–1985: The Miners' Strike, a major battle between government and trade unions.

1985: Live Aid concert raises funds for Ethiopian famine.

1994: Channel Tunnel officially opens



2005 - In 2005 a new Headteacher was appointed to lead Marner her name was Ms Mary Todd.



2005 - On July 6th 2005, London won the Olympic bid. The whole of London celebrated that England would be hosting the Olympics.



2011 - A new extension was added to the school. A central atrium was included which connected the new and existing building.

2012 - In 2012 the Olympics took place. Marner Primary School were chosen to be part of the opening ceremony and appeared on TV across the world, so millions of people saw Marner Primary School pupils take part in the opening ceremony.

2012 - In 2012 a fun, educational Saturday School called Shine was started by Ms Carol Doherty and other staff members with funding from Shine Charity. Shine School provides a wonderful educational place for children to learn.

SHINE 

2000 - 2012

2002: The Golden Jubilee. Queen Elizabeth II marks 50 years on the throne.

2012: London hosted the Olympics. Stratford underwent massive transformation and has become a major commercial, residential and transport hub through extensive regeneration.





2016 - A new Headteacher was appointed to lead Marner, his name was Mr Nick Hague. Sadly, Mr Hague lost his life due to the Covid Pandemic, which had a big impact on the whole school community.

2021 - Ms Janice Long, who was the Deputy Head, took on the roll as Head until a new Headteacher was appointed.

2023 - Ms Sarah Bowmer became the new Headteacher.



The Marner logo was developed over this period to the recently updated version in 2025.

The present logo was developed to represent a stylised compass, which references the maritime connection to the school. The compass needle points in a specific direction which is our schools location in relation to the centre of London.

The six dots represent our six values:
Respect, Happiness, Growth, Hope, Motivation and Community.



2013 - 2020s

2016: Brexit took place, the UK withdrew from the EU, a decision made by public referendum on June 23th 2016.

2020: Covid - global pandemic started in 2020 leading to a global health emergency from March 2020 to May 2023.